

SALES DRAWING SALES DRAWING

SALES DRAWING SALES DRAWING

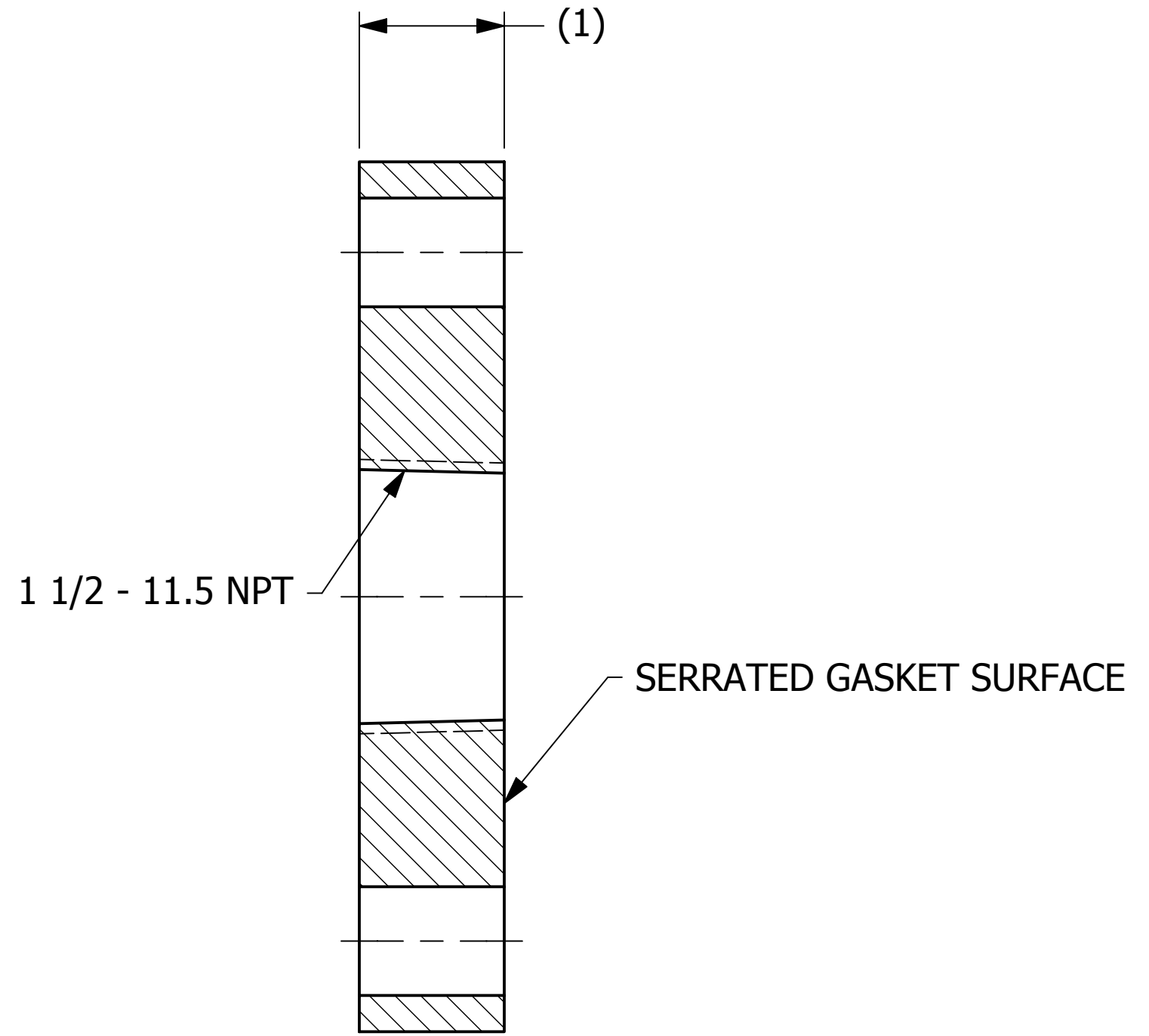
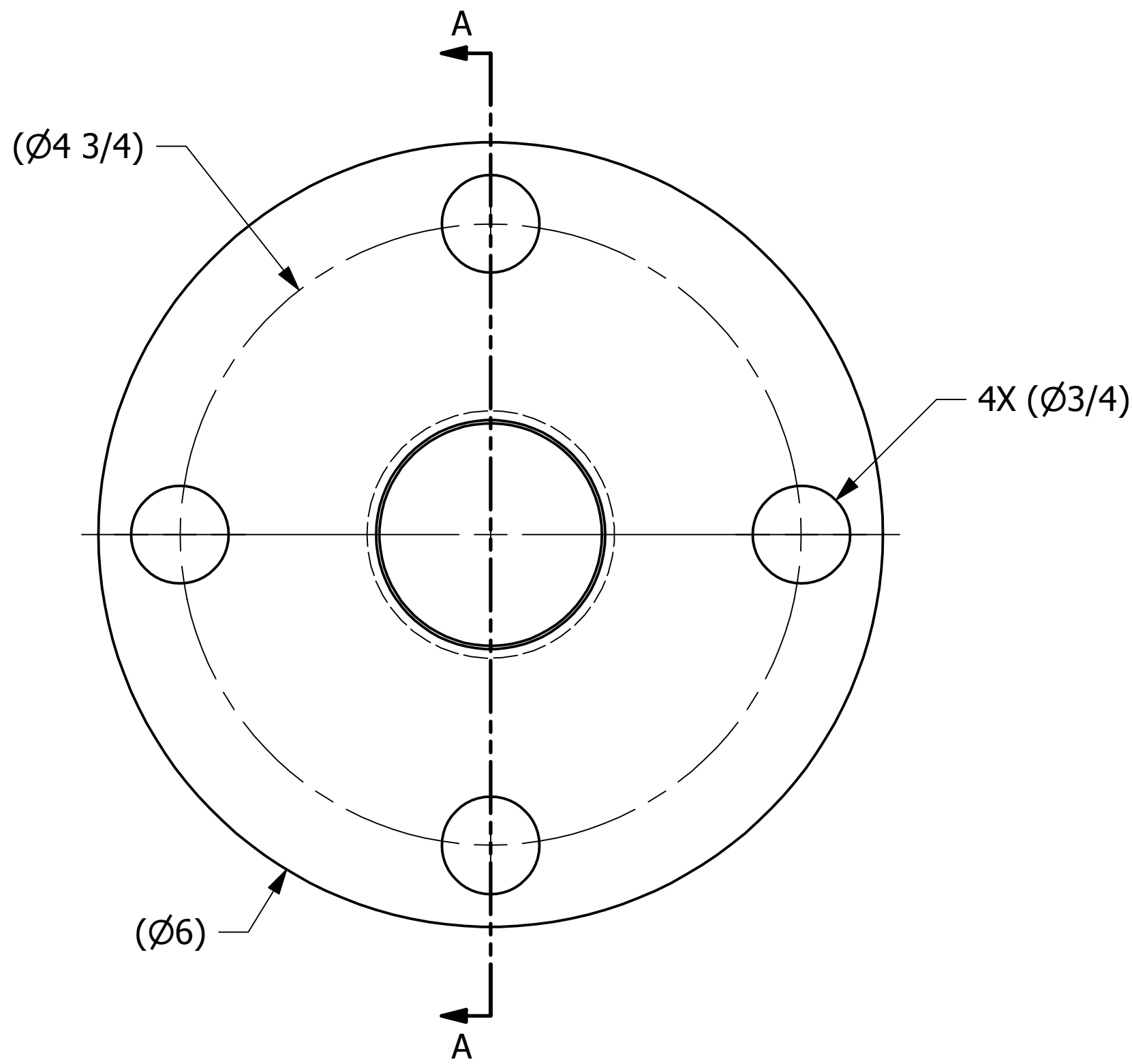

SECTION A-A

UNLESS OTHERWISE SPECIFIED
DIMENSIONAL TOLERANCES
FRACTIONAL: $\pm 1/16$
X.XX: $\pm .03$
X.XXX: $\pm .015$
ANGLE: $\pm 1^\circ$
DEBURR ALL SHARP EDGES.
ALL MACHINED SURFACES TO
HAVE A 125 RMS FINISH UNLESS
NOTED OTHERWISE.

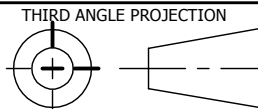

DRAWN BY: REH
CHECKED BY: VD
PROTOTYPE BY: REH
PROTOTYPE DATE: 9/3/2010
APPROVED FOR PRODUCTION BY:
PRODUCTION DATE:

B	BG	5-24-12	UPDATED THREADED HOLE	
A	REH	9-29-10	ADDED PART TO SYSTEM	
REV	BY	DATE	DESCRIPTION	
<div><div><div></div><div></div></div><div>SALCO PRODUCTS, INC.</div></div>				
PART NAME: AIR INLET FLANGE 2"X1 1/2" 150 LB				
MATERIAL: SALCO PE				
PROJECT #:		SHEET #:		SCALE:
WAG0870		1 OF 1		1:1
DRAWING #:		PART #:		
C29391		HS215AIFP		